

Prices
from
£135,000

Hazel End, Phase E

Fanshawe Way, Bishops Stortford, Hertfordshire, CM23 1GU

A brand new development of 2, 3 & 4 bedroom homes

//// ParadigmLiving



CONSUMER
CODE FOR
HOME BUILDERS
www.consumercode.co.uk

REGISTER NOW
& ACTIVATE YOUR
FREE GUARANTEE
0800 032 8936
1 800 814 530

£ Prices from **£135,000 (30% share)**

% Share available 30%-75%

🛏 3 bedrooms



Hazel End E KEY FEATURES

Bathroom suite and thermostatic shower

Carpet fitted in bedrooms & Landing

Tiled flooring in kitchen, vinyl flooring throughout the downstairs

Gas central heating

Allocated parking & Electrical Charge Point

Fitted kitchen with integrated oven and hob

Integrated washing machine and fridge freezer

PV Panels

A brand new development with a collection of 2, 3 & 4 bedroom homes. Located on the doorstep is a 16 Acre country park with green open space. A new primary school and nursery located on the outskirts of the Development.



These particulars do not constitute any part of an offer or contract. Any intended purchasers must satisfy themselves as to the correctness of each of the statements contained in these particulars. All floor layouts maybe subject to changes. The dimensions given on the plan are subject to minor variations intended for guidance only and are not be used for carpets, appliances or items of furniture.

SPECIFICATION

KITCHEN

MANUFACTURER
Symphony kitchen, Urban

COLOUR
Indigo

HANDLES
Brushed bronze arched bridge handle

WORK TOP
**Symphony kitchen, 40mm
laminate Artic Marble**

The specifications and information provided herein are for general informational purposes only and are subject to change without notice. Actual product colours may vary slightly due to differences in screen settings, lighting conditions, and the nature of physical materials. We strive for accuracy but cannot guarantee that digital imagery precisely reflects the final product.

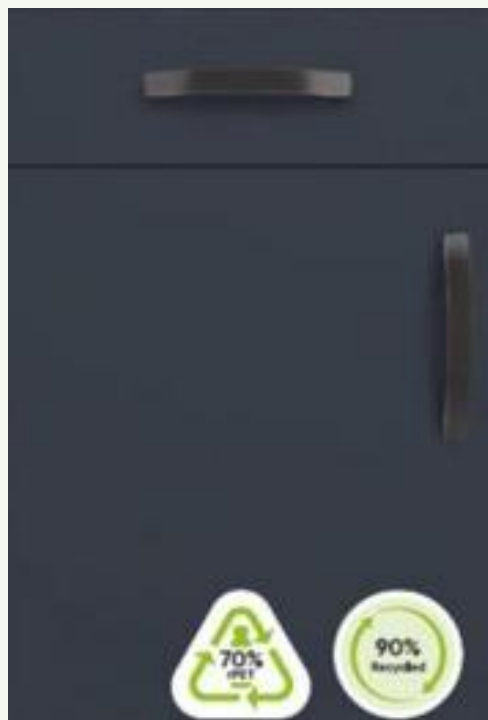

SPECIFICATION

FLOORING

VINYL BRAND
Amtico

COLOUR
Trent Oak

CARPET BRAND
**Abingdon Oakdale Supreme
80/20**

COLOUR
Cool Slate

The specifications and information provided herein are for general informational purposes only and are subject to change without notice. Actual product colours may vary slightly due to differences in screen settings, lighting conditions, and the nature of physical materials. We strive for accuracy but cannot guarantee that digital imagery precisely reflects the final product.

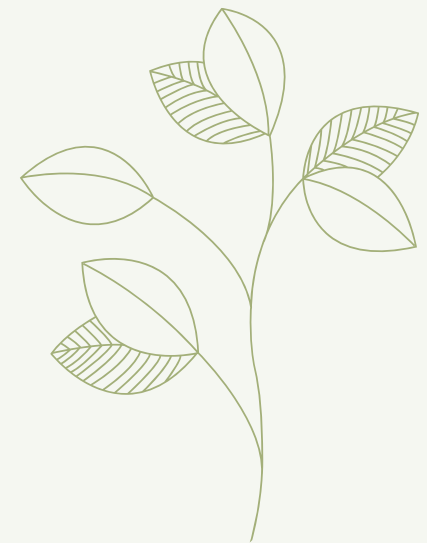



Three Bed House Plots 528, 529*

(* handed)

KITCHEN/DINING

16'11" x 10'11" 5.16m x 3.35m

LIVING ROOM

10'0" x 10'7" 3.07m x 3.24m

BEDROOM 1

9'6" x 15'2" 2.92m x 4.63m

BEDROOM 2

9'6" x 11'5" 2.92m x 3.49m

BEDROOM 3

7'2" x 11'1" 2.20m x 3.38m



GROUND FLOOR

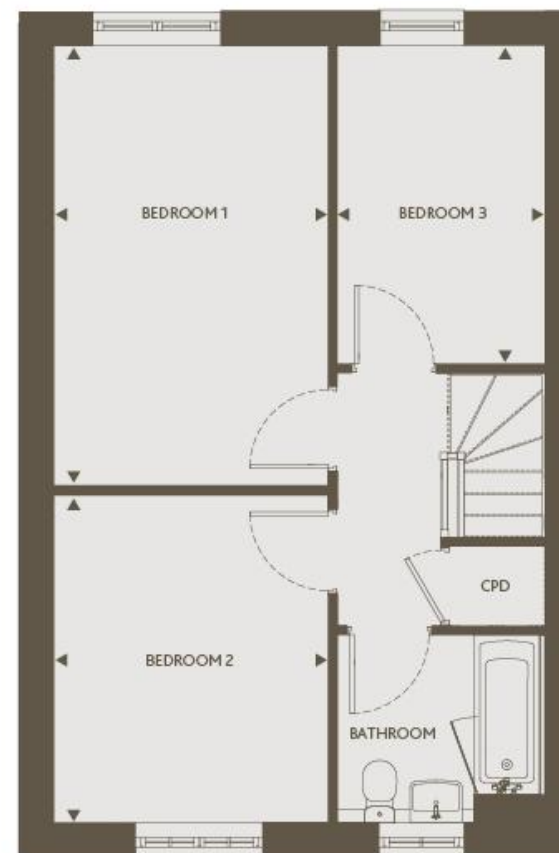

FIRST FLOOR

These particulars do not constitute any part of an offer or contract. Any intended purchasers must satisfy themselves as to the correctness of each of the statements contained in these particulars. All floor layouts may be subject to changes. The dimensions given on the plan are subject to minor variations intended for guidance only and are not to be used for carpets, appliances or items of furniture.





SITE PLAN



Key:

 Affordable rented properties

These particulars do not constitute any part of an offer or contract. Any intended purchasers must satisfy themselves as to the correctness of each of the statements contained in these particulars. All floor layouts may be subject to changes. The dimensions given on the plan are subject to minor variations intended for guidance only and are not to be used for carpets, appliances or items of furniture.



For more information

0300 303 8046

www.paradigmliving.co.uk

These particulars do not constitute any part of an offer or contract. Any intended purchasers must satisfy themselves as to the correctness of each of the statements contained in these particulars. All floor layouts maybe subject to changes. The dimensions given on the plan are subject to minor variations intended for guidance only and are not be used for carpets, appliances or items of furniture.

